

## GSC8042 4G63 RACE BALANCE SHAFT KIT

### INCLUDED IN THIS KIT:

1. (1x) **GSC Billet Race Balance Shaft** (*CNC machined, zero balanced*)
2. (2x) **Aluminum block-off Rings** (*laser marked for installation position*)
3. (1x) **Balance Shaft Delete Cap** (*Caps off the removed balance shaft pulley*)
4. (1x) **Hex Bolt** (*Plugs the hole from removal of balance shaft belt tensioner*)
5. (1x) **Mitsubishi Gear Delete Spacer** (*replaces the balance shaft belt gear*)

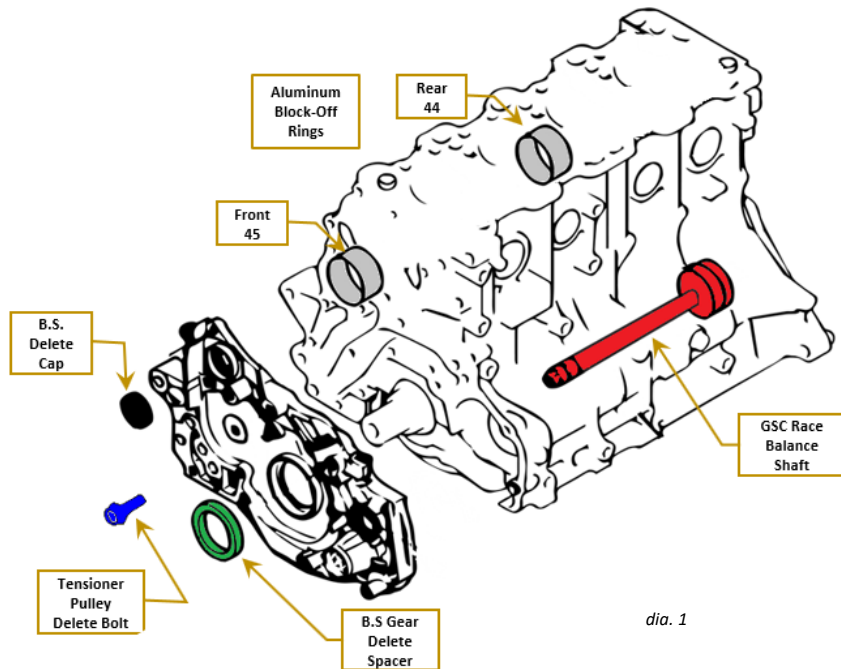

dia. 1



### INSTALLATION TIPS:

-Every OEM part in diagram 2 will be removed and not reused (*except for the front cover*)

-The OEM bearing on the Race Balance Shaft side should stay in the block. If it is damaged and needs to be replaced it is ***Mitsubishi OEM part # MD040598*** **ONLY USE OEM REPLACEMENT**

### -Torque Specs:

-Supplied bolt that replaces the balance shaft belt tensioner:

**23 N-m (17 ft-lb)**

-OEM bolt from oil pump gear to front of race balance shaft:

**36 N-m (26.55 ft-lb)**

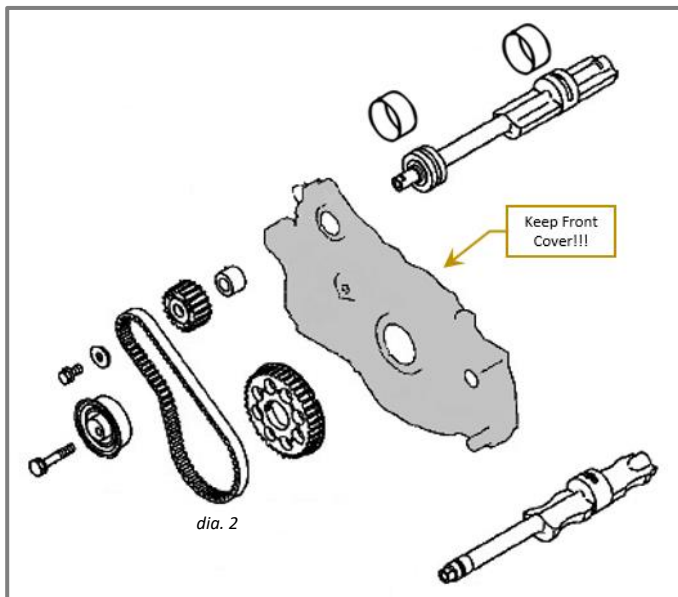

@GSC Power Division



@GSCPower